

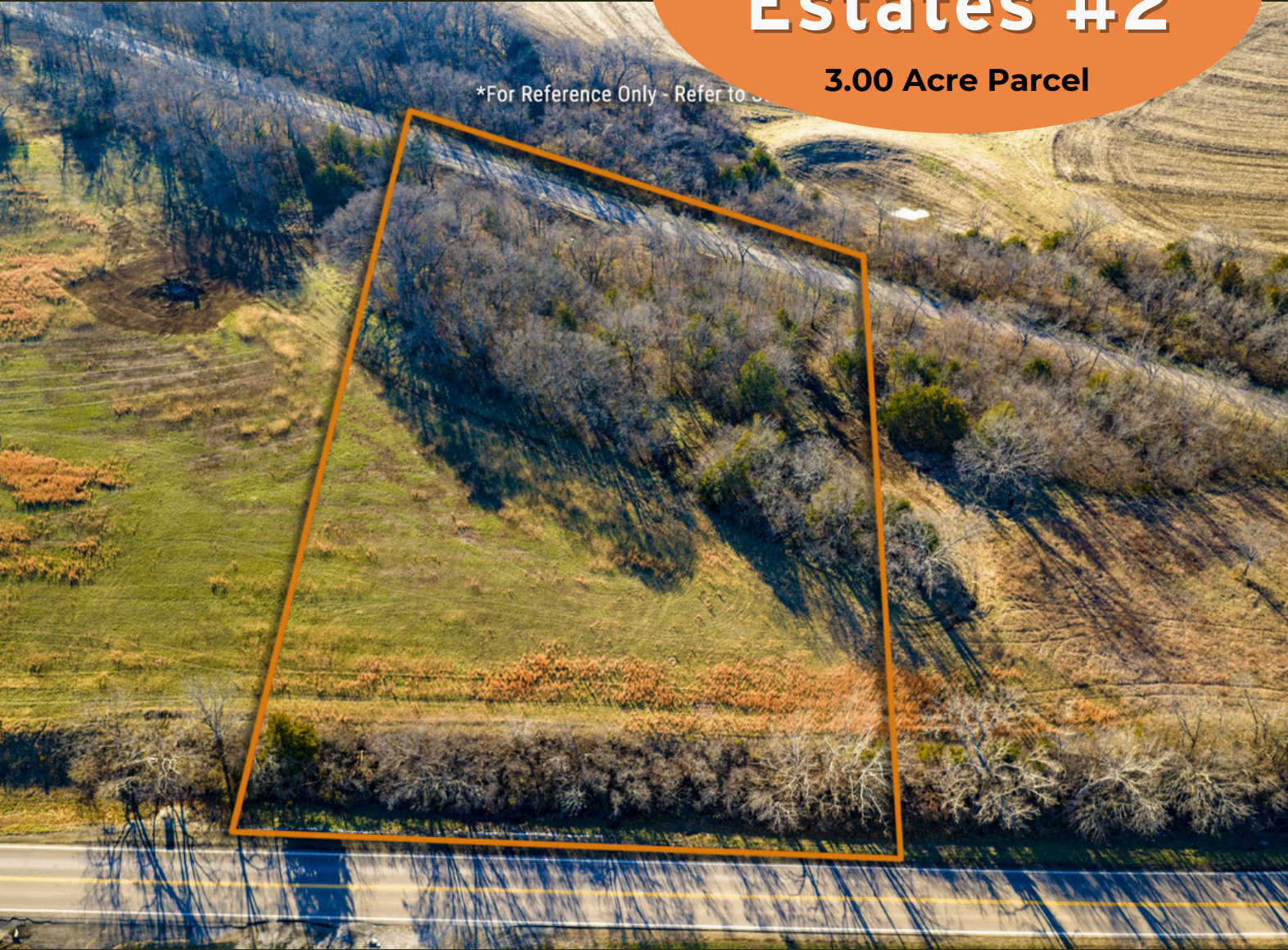

Horizon Ridge Estates #2

3.00 Acre Parcel

*For Reference Only - Refer to...



HORIZON RIDGE ESTATES #2



900 SE Stanley Road, Tecumseh, Kansas

(non-legal address - for reference only)

COUNTY: Shawnee

SIZE: 3.00 Acres

Horizon Ridge Estates Tract 2 is a 3.00-acre canvas with dramatic elevation changes and a natural high point that feels designed for a custom build. Timber along the west side frames the views and helps shield your homesite from neighboring activity, while the interior opens up to expansive vistas over the surrounding countryside. This combination of trees and open space gives you flexibility to orient your home for sunrises, sunsets, or both.

Access is via hard-surfaced roads just off US Highway 40, providing easy routes to Topeka, I-70, and an efficient drive toward Lawrence, while still enjoying the quiet of a lightly traveled area near Tecumseh. Simple protective covenants help maintain an attractive, cohesive neighborhood of estate-style homes without heavy restrictions. Rural water meters and utilities are available, allowing you to move confidently from concept to construction. Tract 2 is an ideal choice for buyers who value topography, trees, and long views in a manageable acreage size.



PRESENTED BY:

Dana Baker

HECK

913-244-3527 Mobile

Dana@heck.realestate

