

HECK

Stillwater Haven

2031a N 1000 Rd, Eudora, KS

30+/- Acres

FOR VISUAL REFERENCE ONLY



Stillwater Haven

HECK

2031a N 1000 Road, Eudora, KS 66025

COUNTY: Douglas | SIZE: 30 +/- Acres | ASKING PRICE: \$360,000

This 30 acre tract located just outside of Eudora, KS offers privacy, versatility, and a great location. Set back off the road with tree lines on three sides, this tract provides an excellent site for a custom home with space for both living and recreation.

The property features 15 acres of tillable ground, 10 acres of timber, a pond, and rolling terrain that offers scenic views and flexible building options. Hard-surface road access and available water meters add convenience for future development.

With a mix of open ground and timber, this acreage is well-suited for a hobby farm, livestock or 4-H projects, or simply enjoying the outdoors. Wildlife is often seen, and the setting provides both open space and natural cover.

Located just 5 minutes from Eudora, 10 minutes from Lawrence or De Soto, and within easy reach of the Kansas City metro, this property combines the appeal of rural acreage with close-to-town access. A unique opportunity to establish your own country homestead in a prime setting.



PRESENTED BY:

Brian Pine
HECK

785-423-1220 Mobile
785-917-5700 Office
Brian@heck.realestate

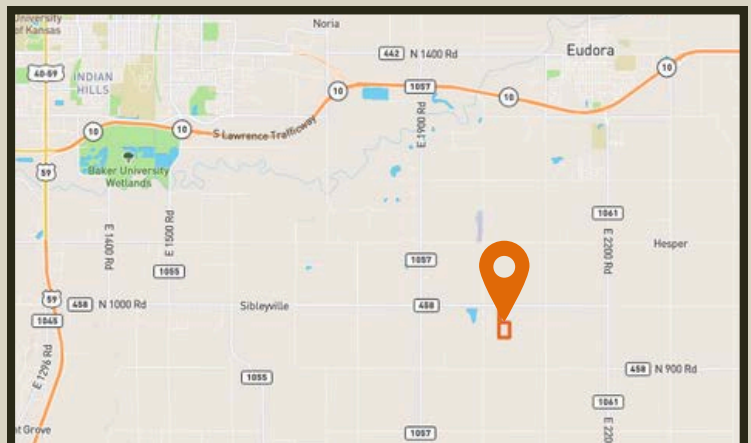

heck.realestate | 3200 Haskell, Suite 130, Lawrence, KS 66046 | 785-917-5700